

# Female Adapters

## PVC Electrical Conduit Fittings and Accessories

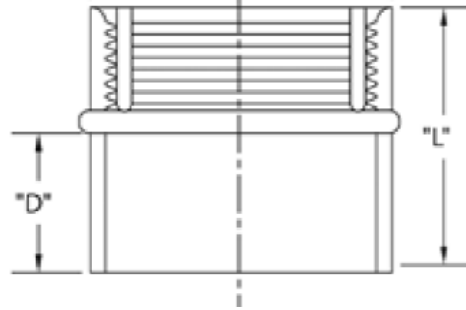

Trade Size (in)	Catalog Part Number	System Part Number	L	D
1/2	FA05	59630	1.44	0.69
3/4	FA07	59631	1.63	0.69
1	FA10	59632	1.88	0.88
1 1/4	FA12	59633	1.94	0.94
1 1/2	FA15	59634	2.13	0.94
2	FA20	59635	2.16	1.21
2 1/2	FA25	59636	3.00	1.31
3	FA30	59637	3.06	1.25
3 1/2	FA35	59638	3.00	1.19
4	FA40	59639	3.25	1.38
5	FA50	59640	3.69	1.31
6	FA60	59641	4.38	1.63
8	FA80	59642	7.00	2.25

- Dimensions are nominal (inches) and are subject to normal manufacturing tolerances
- All sizes conform to UL 651 and NEMA TC-3
  - UL651 does not include 8"
- Images, pictures and dimensions are representative of selected items that may be provided under the part numbers shown. Due to manufacturer specific designs and normal variations allowed by applicable standards, items delivered may differ in some respects