

### CLASS A FITTINGS

#### COUPLINGS

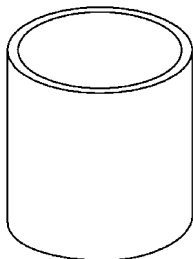

Size	Part #	Package Qty	Weight (lbs)	Master Carton Qty/Wt	Price Per 100
1/2"	59601	200	7	1600/50	\$63.19
3/4"	59602	150	6	1200/52	\$77.98
1"	59603	50	4	600/44	\$120.11
1 1/4"	59604	30	3	360/38	\$160.15
1 1/2"	59605	30	3	240/31	\$223.50
2"	59606	45	9	-	\$290.87
2 1/2"	59607	20	6	-	\$512.31
3"	59608	35	18	-	\$847.29
3 1/2"	59609	25	16	-	\$936.79
4"	59610	18	13	-	\$1,306.99
5"	59611	6	7	-	\$3,307.83
6"	59612	4	6	-	\$4,229.22

#### FEMALE ADAPTERS

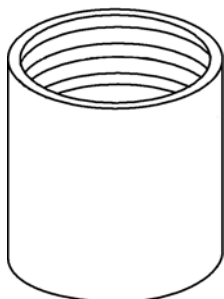

Size	Part #	Package Qty	Weight (lbs)	Master Carton Qty/Wt	Price Per 100
1/2"	59630	200	7	1600/45	\$100.37
3/4"	59631	150	6	1200/50	\$158.44
1"	59632	50	4	600/41	\$214.23
1 1/4"	59633	30	3	360/35	\$286.62
1 1/2"	59634	30	4	240/22	\$304.79
2"	59635	45	9	-	\$415.16
2 1/2"	59636	20	6	-	\$921.18
3"	59637	25	13	-	\$1,149.53
3 1/2"	59638	20	13	-	\$1,504.26
4"	59639	18	13	-	\$1,541.24
5"	59640	10	11	-	\$3,833.46
6"	59641	6	9	-	\$5,060.53

#### TERMINAL ADAPTERS

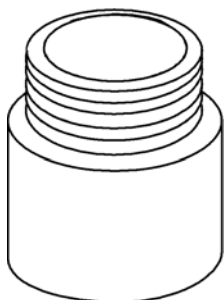

Size	Part #	Package Qty	Weight (lbs)	Master Carton Qty/Wt	Price Per 100
1/2"	59615	200	5	2400/54	\$84.05
3/4"	59616	125	5	1500/49	\$148.75
1"	59617	50	3	600/36	\$187.66
1 1/4"	59618	70	6	840/64	\$241.36
1 1/2"	59619	40	5	480/48	\$291.08
2"	59620	75	12	-	\$418.39
2 1/2"	59621	35	11	-	\$711.31
3"	59622	25	10	-	\$1,042.16
3 1/2"	59623	40	21	-	\$1,345.23
4"	59624	30	18	-	\$1,788.76
5"	59625	10	16	-	\$3,520.57
6"	59626	8	20	-	\$4,232.10